

PALMS OF BEACH PARK
 212 S. CHURCH
 TAMPA FL, 33609

Address Address
 BUILDING 1 - 212 S. Church Ave

MAILING Address
 (3814 W. PLAT ST)
 BUILDING 2

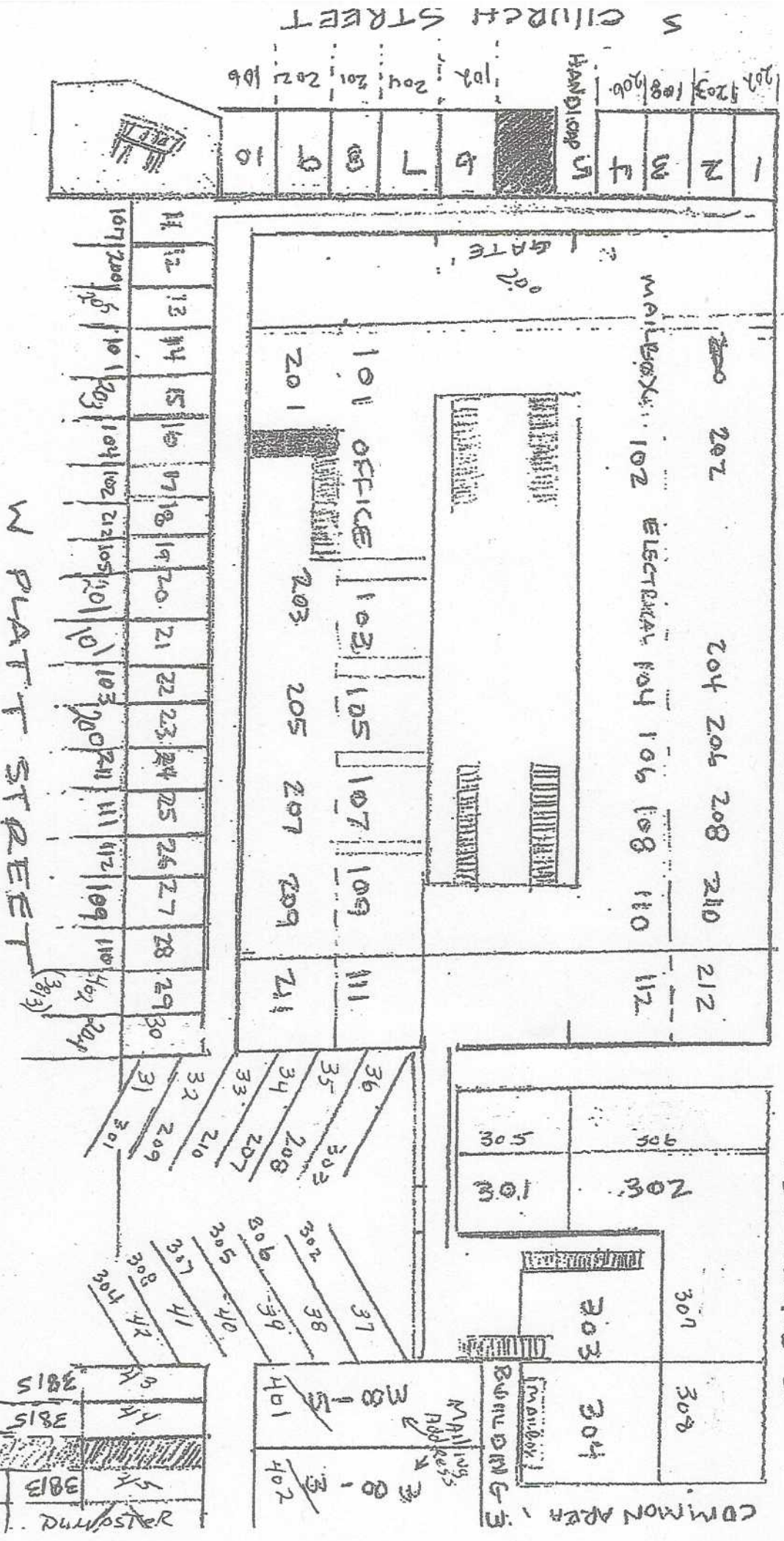

NO PARKING

NO PARKING

3813
 3815
 3815
 3813
 3813
 3813